



## P/N 7853001.5000



Manual hose reel in painted steel s. 700, for air-water, 100 bar, without hose. Drum width 550 mm. Inlet-outlet G 1" (f) with reel flow path in AISI 316 stainless steel

### AREAS OF USE

Manufacturing industry, Mining industry, Shipping and offshore, Railway transport

### FEATURES

|                   |                          |
|-------------------|--------------------------|
| Pressure          | 100 bar                  |
| Compatible fluids | air - water              |
| Swivel joint      | AISI 316 stainless steel |
| Seals             | Viton®                   |
| Characteristic    | manual                   |
| Material          | painted steel            |
| Couplings         | -                        |
| Hose              | -                        |
| ∅ and hose length | -                        |
| Inlet             | G 1" (f)                 |
| Outlet            | G 1" (f)                 |
| Reel flow path    | AISI 316 stainless steel |



### OVERALL DIMENSIONS (mm)

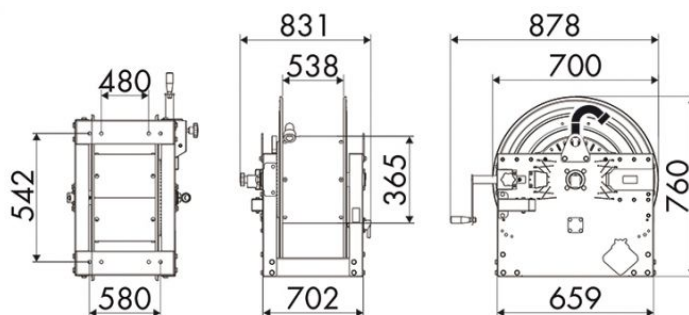

### HOSE REELS CAPACITY

| ∅ 3/8" | ∅ 1/2" | ∅ 3/4" | ∅ 1"  | ∅ 1,1/4" | ∅ 1,1/2" | ∅ 2" |
|--------|--------|--------|-------|----------|----------|------|
| 550 m  | 350 m  | 244 m  | 134 m | 84 m     | 75 m     | 43 m |